



DESCRIPTION

52CS

F x F heavy duty full-flow ball valve with drain-off and red butterfly handle.

According to EN 13828

DIMENSIONS

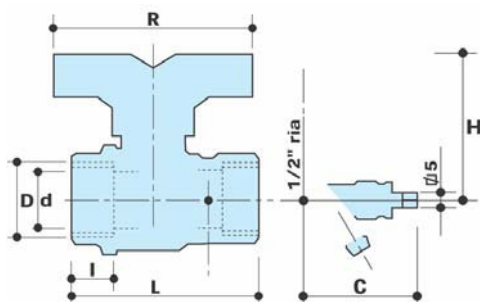

D"	1/2"	3/4"	1"	1 1/4"
d	15	20	25	32
H	46	55.5	65	71
I	12	13	14	16.5
L	54.5	64	73	88
R	58	65	75	75
C	47.5	60.5	64	68.5
Acc.	1	2	3	3
Gr.	261	390	582	835

All threads are in accordance with ISO 7/1 or ISO 228

MATERIALS



- Body** CuZn40Pb2 Cw617N (DIN 50930 part.6)
- Ball** CuZn40Pb2 Cw617N (DIN 50930 part.6)
Diamond polished and chrome plated.
- Spindle** CuZn39Pb3 Cw614N (DIN 50930 part.6)
- Stuffing box** CuZn39Pb3 Cw614N (DIN 50930 part.6)
Adjustable
- Drain** CuZn40Pb2 Cw617N (DIN 50930 part.6)
- Cap** CuZn39Pb3 Cw614N (DIN 50930 part.6)
- Seats** PTFE
- O-rings** 2 x Viton®
PTFE seal
- Lever** Aluminium handle

TAIL VARIANTS

- 52CS F X F, Red butterfly handle
- 52CS/1 F X M, Red butterfly handle

HANDLE VARIANTS

- 50CS Red aluminium lever
- 51CS Red steel lever
- 52CS Red butterfly handle

UNIFIED PRODUCT DESCRIPTION

APPROVALS



PRESSURE DROP DIAGRAM

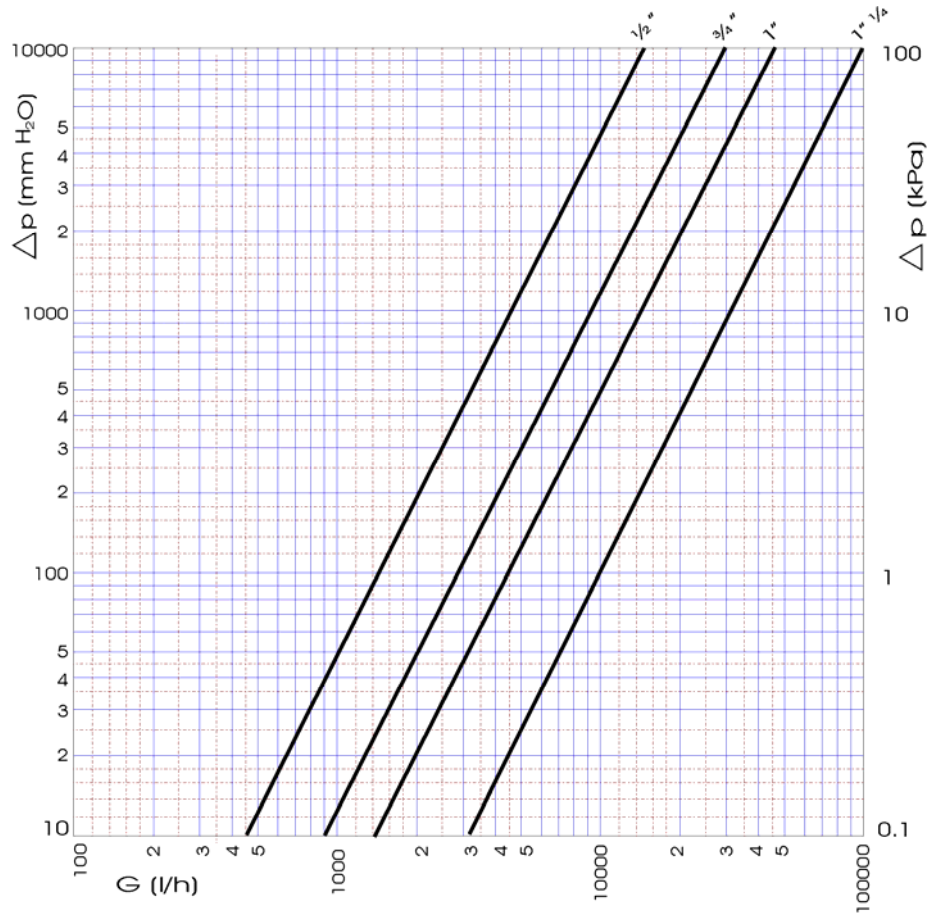

Dim.	1/2"	3/4"	1"	1 1/4"
KV	14.5	30	45	97

TEMPERATURE / PRESSURE DIAGRAM

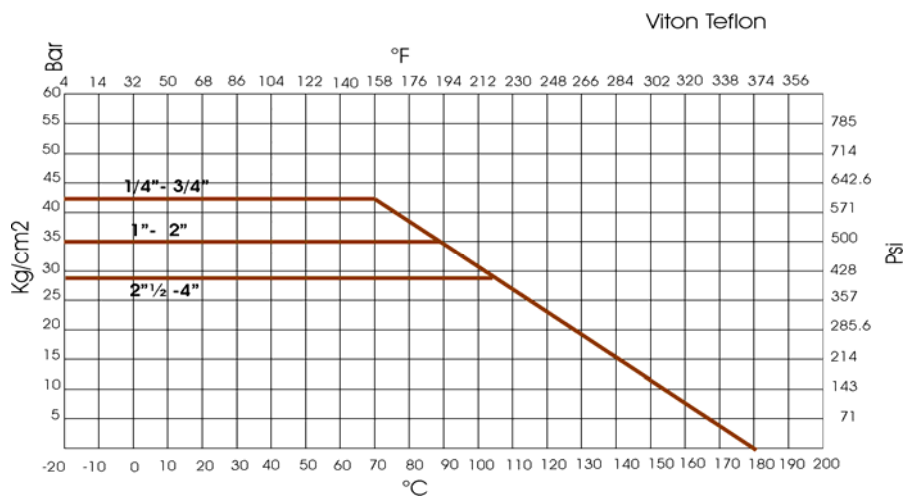

RECOMMENDED WORKING TEMPERATURE/ PRESSURE LIMIT

30 bar - 100°C - non shock
 10 bar - 150°C - non shock